

UNITED STATES DEPARTMENT OF THE INTERIOR
NATIONAL PARK SERVICE

FOR NPS USE ONLY

RECEIVED

DATE ENTERED

**NATIONAL REGISTER OF HISTORIC PLACES
INVENTORY -- NOMINATION FORM**

SEE INSTRUCTIONS IN *HOW TO COMPLETE NATIONAL REGISTER FORMS*
TYPE ALL ENTRIES -- COMPLETE APPLICABLE SECTIONS

1 NAME

HISTORIC Russian Fort

AND/OR COMMON

Russian Fort

2 LOCATION

STREET & NUMBER at Laauokala Pt., east side of Waimea River at its mouth

__ NOT FOR PUBLICATION

CITY, TOWN

CONGRESSIONAL DISTRICT

Waimea

__ VICINITY OF

STATE

CODE

COUNTY

CODE

Hawaii

Kaua'i

3 CLASSIFICATION

CATEGORY	OWNERSHIP	STATUS	PRESENT USE	
<input type="checkbox"/> DISTRICT	<input checked="" type="checkbox"/> PUBLIC	<input checked="" type="checkbox"/> OCCUPIED	<input type="checkbox"/> AGRICULTURE	<input type="checkbox"/> MUSEUM
<input type="checkbox"/> BUILDING(S)	<input type="checkbox"/> PRIVATE	<input type="checkbox"/> UNOCCUPIED	<input type="checkbox"/> COMMERCIAL	<input checked="" type="checkbox"/> PARK
<input checked="" type="checkbox"/> STRUCTURE	<input type="checkbox"/> BOTH	<input type="checkbox"/> WORK IN PROGRESS	<input type="checkbox"/> EDUCATIONAL	<input type="checkbox"/> PRIVATE RESIDENCE
<input type="checkbox"/> SITE	PUBLIC ACQUISITION	ACCESSIBLE	<input type="checkbox"/> ENTERTAINMENT	<input type="checkbox"/> RELIGIOUS
<input type="checkbox"/> OBJECT	<input type="checkbox"/> IN PROCESS	<input type="checkbox"/> YES: RESTRICTED	<input type="checkbox"/> GOVERNMENT	<input type="checkbox"/> SCIENTIFIC
	<input type="checkbox"/> BEING CONSIDERED	<input checked="" type="checkbox"/> YES: UNRESTRICTED	<input type="checkbox"/> INDUSTRIAL	<input type="checkbox"/> TRANSPORTATION
		<input type="checkbox"/> NO	<input type="checkbox"/> MILITARY	<input type="checkbox"/> OTHER:

4 OWNER OF PROPERTY

NAME Division of State Parks, Department of Land and Natural Resources,
State of Hawaii

STREET & NUMBER

CITY, TOWN

STATE

Honolulu

__ VICINITY OF

Hawaii

5 LOCATION OF LEGAL DESCRIPTION

COURTHOUSE,
REGISTRY OF DEEDS, ETC. Bureau of Conveyances

STREET & NUMBER

CITY, TOWN

STATE

Honolulu

Hawaii

6 REPRESENTATION IN EXISTING SURVEYS

TITLE National Survey of Historic Sites and Buildings

DATE

1962

FEDERAL STATE COUNTY LOCAL

DEPOSITORY FOR SURVEY RECORDS Historic Sites Survey Division, Heritage Conservation and Recreation Service

CITY, TOWN

STATE

Washington

D.C.

7 DESCRIPTION

CONDITION		CHECK ONE	CHECK ONE
<input type="checkbox"/> EXCELLENT	<input type="checkbox"/> DETERIORATED	<input type="checkbox"/> UNALTERED	<input checked="" type="checkbox"/> ORIGINAL SITE
<input type="checkbox"/> GOOD	<input checked="" type="checkbox"/> RUINS	<input checked="" type="checkbox"/> ALTERED	<input type="checkbox"/> MOVED DATE _____
<input type="checkbox"/> FAIR	<input type="checkbox"/> UNEXPOSED		

DESCRIBE THE PRESENT AND ORIGINAL (IF KNOWN) PHYSICAL APPEARANCE

The fort is in the form of "an irregular octagon," varying in cross dimension from 300 to 450 feet. The outer walls, still in fair condition, are of piled stone and are from 25 to 45 feet thick and about 20 feet high. Inside the walls can be seen the foundations of the magazine, barracks, and other buildings. The area within and surrounding the fort has been widely cleared for park development as shown in the map accompanying this form.¹ The parking area, comfort station and walk along the north side of the fort have been completed. The area north and east between the fort and the park boundary have been bulldozed in preparation of the park, an action which likely did severe damage to any historical ruins and archeological resources. The area south of the fort to the ocean is overgrown but until recently it was given over to sugar cane. The area has recently been studied and while most of the features indicated on the map could not be documented, a few features were uncovered immediately east of the fort in the area indicated as containing the Whitney House and other houses.² In the area plowed for sugar cane a few cultural remains were uncovered beneath the plow zone suggesting additional values of potential, even in areas plowed.

Originally, beside the for which was equipped with guns and quarters for troops, there was a factory or trading house with gardens and houses for a staff of about 30 families.

¹Russian Fort State Monument, Waimea, Kauai, Hawaii, "Interim Phase I Development Plan, State of Hawaii Division of State Parks, Outdoor Recreation and Historic Sites, Department of Land and Natural Resources, no date.

²Patrick C. McCoy, "Russian Fort...", Report 72-3, Bishop Museum, Honolulu, 1972.

8 SIGNIFICANCE

PERIOD	AREAS OF SIGNIFICANCE -- CHECK AND JUSTIFY BELOW			
<input type="checkbox"/> PREHISTORIC	<input type="checkbox"/> ARCHEOLOGY-PREHISTORIC	<input type="checkbox"/> COMMUNITY PLANNING	<input type="checkbox"/> LANDSCAPE ARCHITECTURE	<input type="checkbox"/> RELIGION
<input type="checkbox"/> 1400-1499	<input type="checkbox"/> ARCHEOLOGY-HISTORIC	<input type="checkbox"/> CONSERVATION	<input type="checkbox"/> LAW	<input type="checkbox"/> SCIENCE
<input type="checkbox"/> 1500-1599	<input type="checkbox"/> AGRICULTURE	<input type="checkbox"/> ECONOMICS	<input type="checkbox"/> LITERATURE	<input type="checkbox"/> SCULPTURE
<input type="checkbox"/> 1600-1699	<input type="checkbox"/> ARCHITECTURE	<input type="checkbox"/> EDUCATION	<input type="checkbox"/> MILITARY	<input type="checkbox"/> SOCIAL/HUMANITARIAN
<input type="checkbox"/> 1700-1799	<input type="checkbox"/> ART	<input type="checkbox"/> ENGINEERING	<input type="checkbox"/> MUSIC	<input type="checkbox"/> THEATER
<input checked="" type="checkbox"/> 1800-1899	<input type="checkbox"/> COMMERCE	<input checked="" type="checkbox"/> EXPLORATION/SETTLEMENT	<input type="checkbox"/> PHILOSOPHY	<input type="checkbox"/> TRANSPORTATION
<input type="checkbox"/> 1900-	<input type="checkbox"/> COMMUNICATIONS	<input type="checkbox"/> INDUSTRY	<input type="checkbox"/> POLITICS/GOVERNMENT	<input type="checkbox"/> OTHER (SPECIFY)
		<input type="checkbox"/> INVENTION		

SPECIFIC DATES 1815-1853

BUILDER/ARCHITECT Dr. Georg Anton Scheffer

STATEMENT OF SIGNIFICANCE

This large stone structure is the most impressive reminder of the attempts by the Russians to gain a position of influence in the Hawaiian Islands during the early 19th century. Alexander Baranov, governor of the Russian American Company at Sitka, wished to open trade with the Hawaiian Islands to obtain food for the Alaska settlements and sent several vessels for this purpose. One of these ships were wrecked at Waimea, Kauai, in 1815; and the next year Baranov sent Dr. Georg Anton Scheffer to recover the cargo and, probably, to open a permanent Russian trading post or to gain a political foothold. Scheffer quickly gained an influence over King Kaumualii, of Kauai, and in the summer of 1816 induced the latter to sign an agreement giving the Russians certain trading and economic rights on Kauai and Oahu. Unsuccessful in an attempt to build a fort at Honolulu, Scheffer returned to Kauai to consolidate his position with Kaumualii. His aim, evidently, was to induce the king to declare his independence of Kamehameha and enter under Russian protection. He first built an earthwork at Hanalai; and, sometime between April and October, 1817, he constructed a strong stone fort at Waimea, over which the Russian flag was flown.

The Waimea establishment was a large one. Besides the fort, which was equipped with guns and quarters for troops, Scheffer had a factory or trading house, with gardens and houses for a staff of about 30 families. Evidently the fort was not entirely finished by the fall of 1817, by which time Scheffer's high-handed conduct had alienated the Hawaiians. Acting on orders from Kamehameha, Kaumualii expelled the Russians.

After the departure of Scheffer from the islands, evidently in October, 1817, the fort was occupied by Hawaiian troops. Here, during 1820, a 21-gun salute was fired when the brig Thaddeus arrived with the son of Kaumualii, who had been attending school in the United States. The first Protestant mission settlement on Kauai was on the river bank near the fort. The Hawaiian garrison was withdrawn and the fort abandoned in or about 1853.

9 MAJOR BIBLIOGRAPHICAL REFERENCES

- A. P. Taylor, "Russia's Monument to Intrigue in Hawaii," in Honolulu Advertiser, January 28, 1923.
 R. S. Kuykendall, The Hawaiian Kingdom, 1778-1854, pp. 55-60.
 E. W. Daman, Koamalu..., I, 255-256.
 T. H. Hadley and M. S. Williams, Kauai (4th ed., 1956), 79-80 (maps).
 John A. Hussey, National Survey form, "Russian Fort near Waimea, Historic Sites

10 GEOGRAPHICAL DATA Survey, National Park Service, 1958.

ACREAGE OF NOMINATED PROPERTY 17.5 acres

UTM REFERENCES

A	0,4	4	3,1	2,9,0	2,4	2,8	0,8,0	B	0,4	4	3,0	9,8,0	2,4	2,7	8,1,0
	ZONE		EASTING		NORTHING				ZONE		EASTING		NORTHING		
C	0,4	4	3,0	8,7,0	2,4	2,7	9,1,0	D	0,4	4	3,1	1,4,0	2,4	2,8	1,7,0

VERBAL BOUNDARY DESCRIPTION The boundary is shown in red on the accompanying Tax Map Key of Hawaii, Zone 1, Sec. 7, Plat 05-Kauai and the Interim Phase I Development Plan footnoted in Sec. 7 of this form. The boundary is coterminus with the boundary of parcel 3 as shown on the tax map. Generally it is bounded by the south edge of the Kauai Belt Road, the northwest boundary of parcel 4, the shoreline of the ocean and the eastern shoreline of Waimea River. Not contributing to the significance of the landmark are the parking area and rest rooms. (CONTINUED)

LIST ALL STATES AND COUNTIES FOR PROPERTIES OVERLAPPING STATE OR COUNTY BOUNDARIES

STATE	CODE	COUNTY	CODE
STATE	CODE	COUNTY	CODE

11 FORM PREPARED BY

NAME / TITLE

Benjamin Levy, Historian

ORGANIZATION Historic Sites Survey Division, Heritage

DATE

Conservation and Recreation Service

August 1978

STREET & NUMBER

TELEPHONE

1100 L Street NW.

202-523-5464

CITY OR TOWN

STATE

Washington

D.C. 20240

12 STATE HISTORIC PRESERVATION OFFICER CERTIFICATION

THE EVALUATED SIGNIFICANCE OF THIS PROPERTY WITHIN THE STATE IS:

NATIONAL

STATE

LOCAL

As the designated State Historic Preservation Officer for the National Historic Preservation Act of 1966 (Public Law 89-665), I hereby nominate this property for inclusion in the National Register and certify that it has been evaluated according to the criteria and procedures set forth by the National Park Service.

FEDERAL REPRESENTATIVE SIGNATURE

TITLE

DATE

FOR NPS USE ONLY

I HEREBY CERTIFY THAT THIS PROPERTY IS INCLUDED IN THE NATIONAL REGISTER

DATE

9/8/83

ATTEST:

DATE

KEEPER OF THE NATIONAL REGISTER

UNITED STATES DEPARTMENT OF THE INTERIOR
NATIONAL PARK SERVICE

FOR NPS USE ONLY
RECEIVED
DATE ENTERED

**NATIONAL REGISTER OF HISTORIC PLACES
INVENTORY -- NOMINATION FORM**

Russian Fort

CONTINUATION SHEET

ITEM NUMBER 10 PAGE 2

Justification: The boundary of the park closely encompasses the primary resource of the landmark--the fort itself--and a prudent setting containing associated resources, some identified others supported by historic narrative. The area surrounding the fort was likely used for gardens associated with the post trader's occupation, even though the precise location of the gardens has not been documented. The bounded area is smaller than the original reservation, much of which is impacted today. It is defined by natural and obvious features such as the ocean and river and Belt Road, as well as the limit of neighboring sugar cane cultivation.

Russian Fort, Waimea, Kaua'i, Hawai'i
 Tax Map Key, Bureau of Conveyances, State of Hawai'i
 Current to 1978

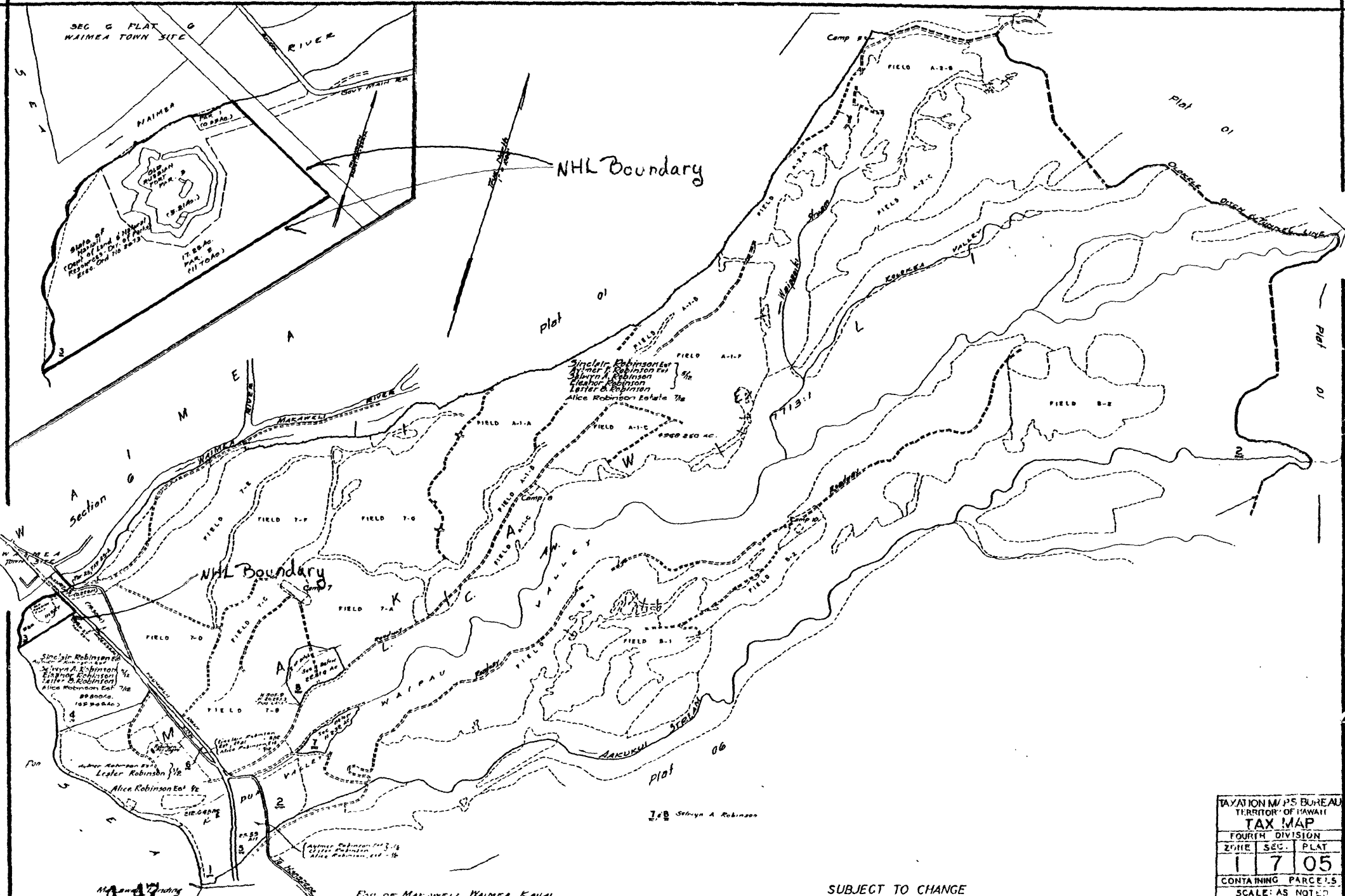

SEC 6 PLAT 6
 WAIMEA TOWN SIDE

NHL Boundary

NHL Boundary

TAXATION MAPS BUREAU		
TERRITORY OF HAWAII		
TAX MAP		
FOURTH DIVISION		
ZONE	SEC.	PLAT
1	7	05
CONTAINING PARCELS		
SCALE: AS NOTED		

SUBJECT TO CHANGE

END OF MAKAWELL WAIMEA KAUA'I